

GAPOSA® QCXSUN



Funk-Sonnensensor, 1-Kanal
mit Saugnapfbefestigung an der Scheibe



GAPOSA®

GAPOSA srl
via Ete, 90 - 63900 Fermo - Italy
T. +39.0734.22071 - F. +39.0734.226389
info@gaposa.com - www.gaposa.com



QCXSUN_ML_1014

QCXSUN was developed for all GAPOSA radio motors installed **in interior/exterior blinds or roller shutters.**

NOTE: Before starting the programming procedure it is necessary to check which interior blind, exterior blinds or roller shutters will be controlled by the sun sensor.

1. HOW DOES IT WORK

SENSOR OFF. The sensor is completely inactive. It does not measure light intensity nor transmits radio signals.

SENSOR ON. The sensor measures light intensity every 90 seconds (1 flash of the LED).



When the sensor detects an increase in brightness (above the threshold) it closes the blind/shutter and stops measuring light intensity for 20 minutes before starting again every 90 sec.

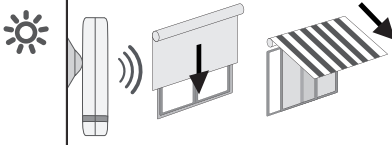



When the sensor detects a decrease in brightness (below the threshold) it opens the blind/shutter and stops measuring light intensity for 1 minute before starting again every 90 sec

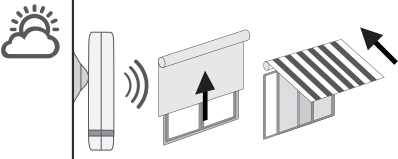

NOTE: When the battery is inserted for the first time, the default factory setting of the sun sensor is OFF with a threshold of 1 (low light)

2. FUNCTIONS

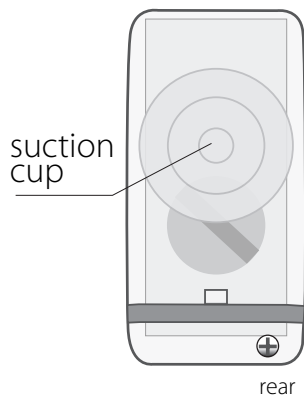
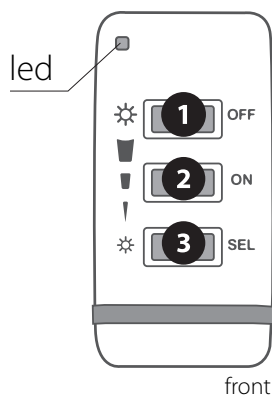

- ❶ OFF - Disables the sun sensor (1 slow flash)
- ❷ ON - Activates the sun sensor (3 quick flashes)
- ❸ SEL - Sun sensibility threshold adjustment

2. PROGRAMMING QCXSUN

IMPORTANT: QCXSUN sensor can only be programmed once the radio motor has already been programmed to a transmitter.

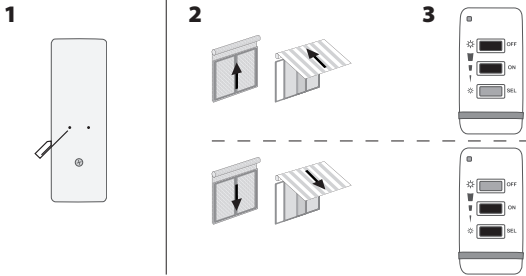

- 1 Press and hold PROG-TX button of the MASTER transmitter till the motor starts moving
- 2 Check the motor rotation then release Prog-TX button
- 3 Press 1+2 (if motor move UP) or 2+3 (if motor move DOWN) button of the QCXSUN

Transmitter is now programmed

3. SUN SENSIBILITY THRESHOLD ADJUSTMENT

1. Press and hold BUTTON 3 (the LED will turn on at first) until the LED starts to flash slowly, release BUTTON 3
2. Adjust the threshold by using BUTTONS 1 and 3 which will allow you to either increase (Button 1) or decrease (Button 3) the threshold.
Whenever a button is pressed the LED flashes according to the level of sun threshold (1, 2 or 3).

Threshold 1 - 5 Klux (default)	= Low light (most sensitive)	> led flashes 1 time
Threshold 2 - 30 Klux	= Med Light	> led flashes 2 time
Threshold 3 - 60 Klux	= High light (less sensitive)	> led flashes 3 time

3. Once the desired threshold has been obtained press BUTTON 2 to confirm.

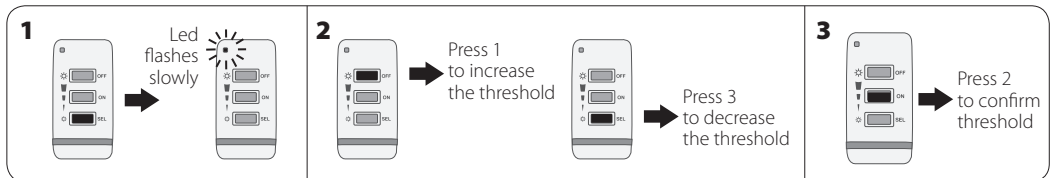

NOTE: It is important to program the sun sensor's threshold within 30 seconds or the time out function will automatically exit the programming procedure without saving the new threshold.

4. ADDITIONAL FUNCTIONS (AS A NORMAL TRANSMITTER)

Buttons 1+2= opening command to programmed blinds/shutter;

Buttons 2+3 = closing command to programmed blinds/shutters.

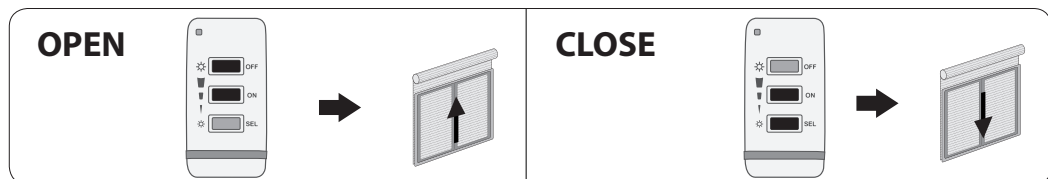

5. REPLACING THE BATTERY

1. Remove the rubber band, the screw and the back cover;

IMPORTANT: While replacing the battery, it is extremely important to be very careful and to not damage the sun sensor.

2. Take out the electronic board and remove the battery;

3. Position the battery (CR2450) according to polarity;

4. Reinstall the back cover, the screw and the rubber band.

